

# Scroll Dry Vacuum Pump DIS/DVS/DISL Series

## Features

- Oil free and clean vacuum
- Low noise and low vibration
- Light weight and compact
- Environmentally friendly
- A lineup to cover every need.

## Applications

- Vacuum drying system
- Scientific and chemical experiments, and analyzing appliances
- Etching system
- Backing pump for dry vacuum system
- Helium leak detector
- Adsorption and transport systems
- Vacuum heat treatment system
- Medical appliances

### Scroll Dry Vacuum Pump

## DIS-090



With built-in thermal protector/With gas ballast

### External Dimension Diagram (unit: mm)

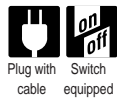

Plug with cable Switch equipped

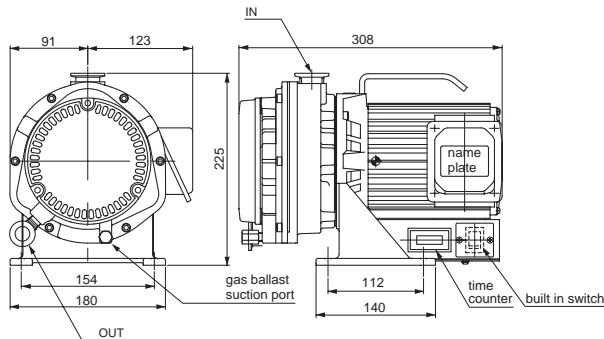

### Specifications

Unit	DIS-090	
Pumping Speed	L/min.	90/108 (50/60Hz)
Ultimate pressure	Pa	5.0
Motor	Single phase, 100/115/200/230V, 150W, 4P	
Full load current	A	50Hz 2.6/1.3/1.6(100/200/230V)
		60Hz 2.1/2.2/1.1/1.1(100/115/200/230V)
Weight	kg	14.0
Inlet, outlet pipe diameter	IN KF25 OUT KF16	
Ambient operation temp. range	°C	5 ~ 40
Max. water vapor tolerance	g/hr	≤5 g/day (when gas ballast valve is open)
Noise(at a distance of 1m)	dB	≤52 (when gas ballast valve is open ≤57)
Overall dimensions	mm	214(W) x 308(L) x 225(H)

### Scroll Dry Vacuum Pump

## DVS-321



With built-in thermal protector/With gas ballast

### External Dimension Diagram (unit: mm)



With terminal without cable

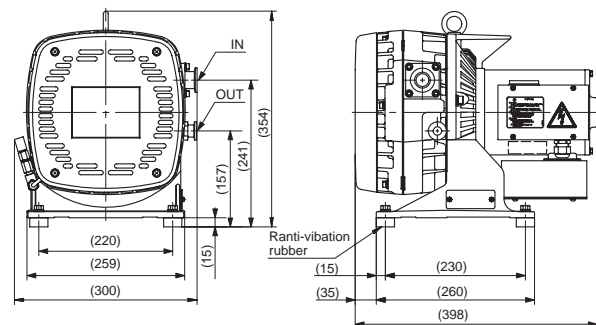

### Specifications

Unit	DVS-321	
Pumping Speed	L/min.	265/320 (50/60Hz)
Ultimate pressure	Pa	1.5 (after fitting device sold separately)
Motor	Single phase 100/115/200/230V, 400W, 4P	
Full load current	A	50Hz 5.3/2.9/3.0(100/200/230V)
		60Hz 4.6/4.1/2.5/2.3(100/115/200/230V)
Weight	kg	35.0
Inlet, outlet pipe diameter	IN KF25 OUT KF16	
Ambient operation temp. range	°C	5 ~ 35
Max. water vapor tolerance	g/hr	≤2 (after fitting device sold separately)
Noise(at a distance of 1m)	dB	≤60/65 (50/60Hz)
Overall dimensions	mm	300(W) x 398(L) x 354(H)

• DIS/DISL Series

Model	Pumping Speed (L/min)	Ultimate pressure (Pa)	Motor	Weight (kg)	Inlet/Outlet pipe dimensions	Overall dimensions W x L x H (mm)
*DIS-090	50Hz 90 60Hz 108	5.0	Single phase, 100/115/200/230V, 150W,4P	14.0	IN KF25 OUT KF16	214 x 308 x 225
DIS-250	50Hz 250 60Hz 300	1.6	Three phase, 200/208/230/380/415/460V, 400W,4P	23.0	IN KF25 OUT KF16	252 x 370 x 336
*DIS-250	50Hz 250 60Hz 300	1.6	Single phase, 100/115/200/230V, 400W,4P	25.0	IN KF25 OUT KF16	252 x 400 x 336
DIS-500	50Hz 500 60Hz 600	1.0	Three phase, 200/208/230/380/415/460V, 400W,4P	38.0	IN KF40 OUT KF25	290 x 372 x 397
*DIS-500	50Hz 500 60Hz 600	1.0	Single phase, 100/115/200/230V, 400W,4P	44.0	IN KF40 OUT KF25	290 x 443 x 397
*DVS-321	50Hz 265 60Hz 320	1.5	Single phase, 100/115/200/230V, 400W,4P	35.0	IN KF25 OUT KF16	300 x 398 x 354
DVS-631	50Hz 525 60Hz 630	1.0	Three phase, 200/220/230V, 600W,4P	44.0	IN KF40 OUT KF25	326 x 412 x 367
*DVS-631	50Hz 525 60Hz 630	1.0	Single phase, 100/115/200/230V, 600W,4P	50.0	IN KF40 OUT KF25	338 x 491 x 367
*DISL-100	50Hz 100 60Hz 120	50.0	Single phase, 100/115/200/230V, 300W,4P	15.0	IN KF25 OUT KF16	220 x 350 x 237
DISL-500	50Hz 430	10.0	Three phase, 200/380/415V, 900W,2P	52.0	KF25	318 x 503 x 361
	60Hz 520		Three phase, 200/208/230/460V, 1100W,2P			

\* : With built-in thermal protector

## Scroll Dry Vacuum Pump DISL-500



With gas ballast

### External Dimension Diagram (unit: mm)

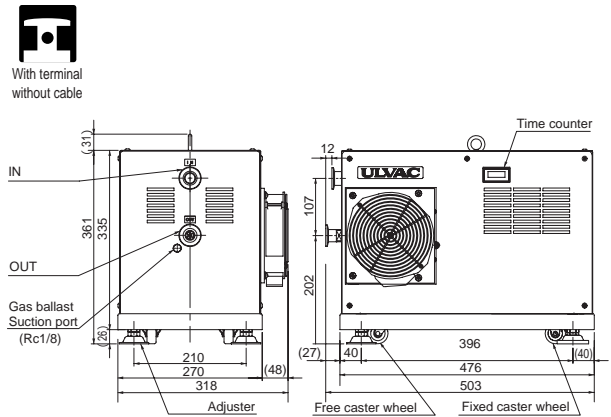

### Specifications

Unit	DISL-500	
Pumping Speed	L/min.	430/520(50/60Hz)
Ultimate pressure	Pa	10.0
Motor	50Hz	Three phase, 200/380/415V, 900W, 2P
	60Hz	Three phase, 200/208/230/460V, 1100W, 2P
Full load current	50Hz	3.6/1.9/1.8 (200/380/415V)
	60Hz	4.2/4.1/3.9/1.95 (200/208/230/460V)
Weight	kg	52.0
Inlet pipe diameter		KF25
Ambient operation temp. range	°C	5 ~ 40
Max. water vapor tolerance	g/hr	≤10 (≤5 g/day (when gas ballast valve is open))
Overall dimensions	mm	318(W) x 503(L) x 361(H)

### Pumping Speed Curve

#### DIS Series

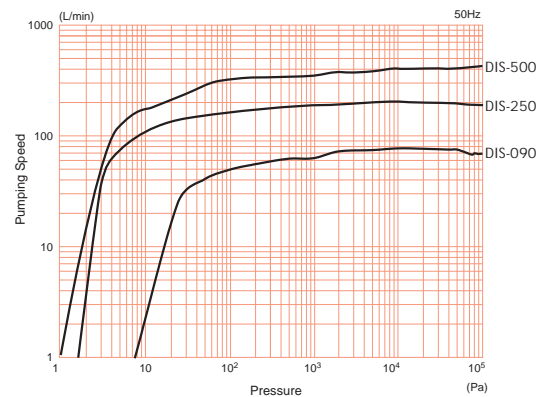

#### DVS Series

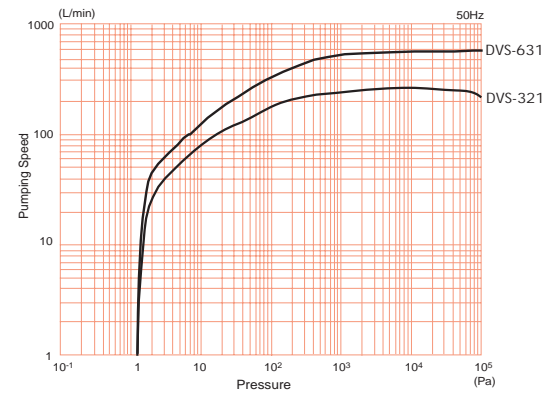

#### DISL Series

