

Diaphragm Type Dry Vacuum Pump (Chemical Type) DTC Series

Features

- All components that see the gas are made in PTFE.
- Suitable for pumping out corrosive gas or organic solvent.
- High vacuum down to 1000Pa.
- Compact.

Applications

- Rotary evaporator
- Evaporating system
- Vacuum Concentrator
- Vacuum filtration
- Exhaust of gas-transfer tube
- Vacuum drying systems
- Laser-gas circulation

Diaphragm Type Dry Vacuum Pump (Chemical type)

DTC-21/21K



組込型 DTC-21K

With built-in thermal protector

Diaphragm Type Dry Vacuum Pump (Chemical type)

DTC-60



With built-in thermal protector

External Dimension Diagram (unit: mm)

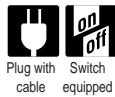

Plug with cable
Switch equipped

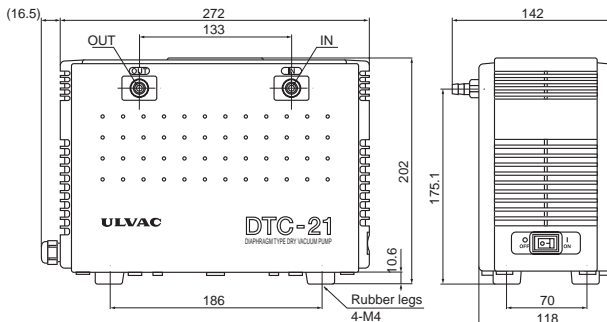

The Diagram is for DTC-21

External Dimension Diagram (unit: mm)

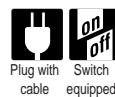

Plug with cable
Switch equipped

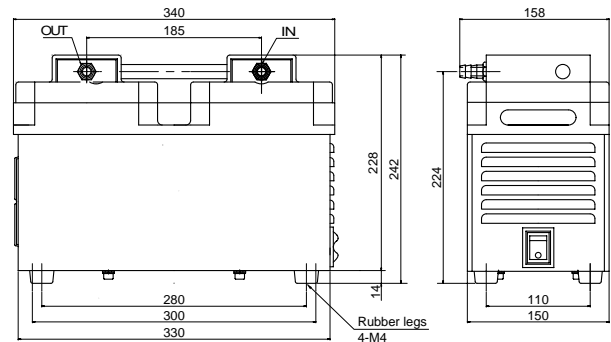

Specifications

Unit	DTC-21	DTC-21K
Actual Pumping Speed	L/min 20/24 (50/60Hz)	
Ultimate pressure	Pa 1.0 x 10 ³	
Motor	Single phase, 100V, 50W, 4P, Condenser run	
Full load current	A 1.3	
Weight	kg 7.3	kg 7.2
Inlet, outlet pipe diameter	mm O.D 9 x I.D 5 (G1/4)	
Ambient operation temp. range	°C 0 ~ 40	
Overall dimensions	mm 142 (W) x 288.5 (L) x 202 (H)	mm 125 (W) x 242 (L) x 184 (H)

Specifications

Unit	DTC-60
Actual Pumping Speed	L/min 60/70 (50/60Hz)
Ultimate pressure	Pa 1.0 x 10 ³
Motor	Single phase, 100V, 200W, 4P, Condenser run
Full load current	A 3.6/3.7 (50/60Hz)
Weight	kg 18.0
Inlet, outlet pipe diameter	mm O.D 14 x I.D 9 (G3/8)
Ambient operation temp. range	°C 0 ~ 40
Overall dimensions	mm 158 (W) x 340 (L) x 242 (H)

• DTC Series

Model	Actual Pumping Speed (L/min)	Ultimate pressure (Pa)	Motor	Weight (kg)	Inlet pipe dimensions O.D. x I.D. (mm)	Overall dimensions W x L x H (mm)
*DTC-21/21K	20/24(50/60Hz)	1.0×10^3	Single phase, 100V, 50W, 4P, Condenser run	7.3/7.2	9 x 5	142 x 288.5 x 202/125 x 242 x 184
*DTC-41/41K	40/46(50/60Hz)	1.0×10^3	Single phase, 100V, 100W, 4P, Condenser run	10.3/10.2	9 x 6	155 x 336.5 x 217/136 x 288 x 202
*DTC-60	60/70(50/60Hz)	1.0×10^3	Single phase, 100V, 200W, 4P, Condenser run	18.0	14 x 9	158 x 340 x 242
*DTC-120	120/140(50/60Hz)	1.0×10^3	Single phase, 100V, 400W, 4P, Condenser run	27.5	16 x 10	203 x 411 x 300

* : With built-in thermal protector

Diaphragm Type Dry Vacuum Pump (Chemical type)

DTC-120



External Dimension Diagram (unit: mm)



Plug with cable Switch equipped

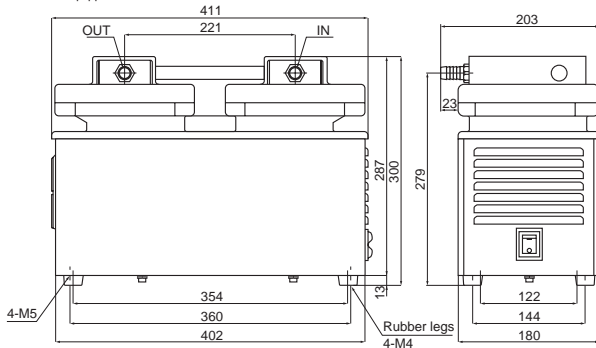

Specifications

Unit	DTC-120
Actual Pumping Speed	L/min 120/140 (50/60Hz)
Ultimate pressure	Pa 1.0×10^3
Motor	Single phase, 100V, 400W, 4P, Condenser run
Full load current	A 5.3/6.0 (50/60Hz)
Weight	kg 27.5
Inlet, outlet pipe diameter	mm O.D 16 x I.D 10 (G1/2)
Ambient operation temp. range	°C 0 ~ 40
Overall dimensions	mm 203(W) x 411(L) x 300(H)

Attention : DTC Series are an exporting restriction product. Pursuant to the regulation of foreign exchange and foreign trade control, in case they are exported out of Japan, a general license of an export authorization is required.

Pumping Speed Curve

DTC Series

